

## SINGLE HYDRANT GATE VALVES



Figure No. 5150

**STANDARD EQUIPMENT:** brass body with brass trim, swivel inlet with pin lug. 2 1/2" size only. Red hand wheel.

**OPTIONAL TRIM :** Swivel inlet with rocker lugs.

**SPECIFY  
THREAD**

U/L LISTED AND FM APPROVED



Figure No. 5155

**STANDARD EQUIPMENT:** solid top, brass body, painted red with polished brass trim, swivel inlet with pin lug. 2 1/2" size only.

**OPTIONAL TRIM :** Swivel inlet with rocker lugs.

**SPECIFY  
THREAD**

Figure No. 5155 available with crank handle, tee handle or wheel handle. Specify handle required.

## GLOBE VALVES - 300 LB. RATED

### FEMALE X MALE

For Use as a Fire Dept. Outlet Connection

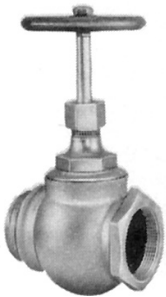

Figure No. 5210-5215

**STANDARD EQUIPMENT:** Female NPT inlet X Male hose thread outlet, cast brass with wheel handle. 300PSI

Figure No. 5210 Size 1 1/2"  
5215 2 1/2"

### DOUBLE FEMALE

For Use with a Fire Hose Rack Assembly

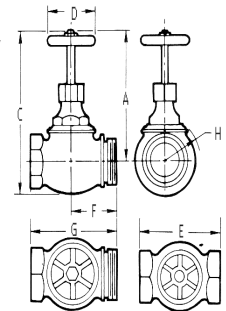

**STANDARD EQUIPMENT:** Female NPT inlet and outlet, cast brass with wheel handle. 300 PSI.

Figure No. 5220 Size 1 1/2"  
5225 2 1/2"

Size	A Clo.	B	C Clo.	C Open	D	E	F	G	H
1 1/2	5 1/2	2 1/4	7 1/16	8 1/16	3 1/2	4 1/2	2 9/16	4 5/8	2 11/16
2 1/2	8 1/2	3 9/16	10 1/14	11 3/16	5	6 3/4	3 1/2	6 15/16	3 3/16

**SPECIFY  
THREAD**

**OPTIONAL FINISHES:**

- PB - Polished Brass
- RC - Rough Chrome Plated
- PC - Polished Chrome Plated

## WHARF HYDRANT VALVES

For Use as a Fire Dept Outlet Connection. Designed to Prevent Unauthorized Use.



Figure No. 5235-5245

**STANDARD EQUIPMENT:** Female NPT inlet X Male hose thread outlet, cast brass, hydrostatically tested to 300lbs. Pentagonal nut at top of spindle.

Figure No. 5235 Size 2 1/2" x 2 1/2"  
5240 3" x 2 1/2"  
5245 4" x 2 1/2"

**SPECIFY  
THREAD**

## DOUBLE HYDRANT GATE VALVES

For use as a Fire Dept Outlet Connection.

**STANDARD EQUIPMENT:** 4" or 6" Female NPT inlet X Two Male hose thread on valves. Consists of roof body with two Fig. No. 5135 - 2 1/2" non-rising stem 300 lb. Gate valves with caps and chains, cast brass.

**Note:** Also available three-way.

Figure No. 5250 4 X 2 1/2" X 2 1/2"  
5260 6 X 2 1/2" X 2 1/2"



Figure No. 5250

**SPECIFY  
THREAD**